

At the second maintenance job,
then every 15 000 km / 10 000 miles

Types 100 109

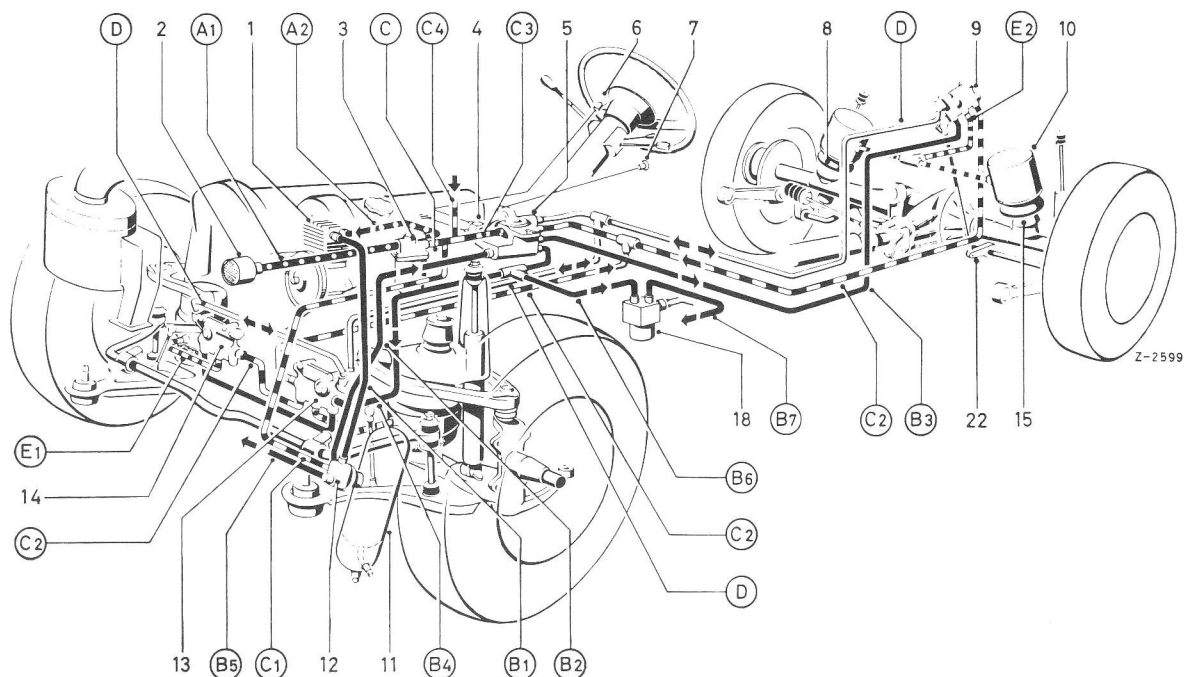

Type 100

- 1 Air compressor
- 2 Air filter
- 3 Anti-freeze device
- 4 El. pressure switch for warning lamp
- 5 Valve unit
- 6 Warning lamp (red)
- 7 Valve unit cable
- 8 Air bellows
- 9 Rear level control valve unit
- 10 Air chamber
- 11 Air reservoir tank
- 12 Pressure regulator
- 13 Front left level control valve
- 14 Front right level control valve
- 15 Air piston
- 18 Actuating valve for air horn
- 22 Torsion bar lever
- A Intake line
- B Pressure line
- C Return flow line
- D Air control line
- E Connecting line between level control valve and air suspension

- A1 Intake pipe and air release line from air filter to anti-freeze device
- A2 Intake line from anti-freeze device to air compressor
- B1 Pressure line (full operational pressure) from air compressor to pressure regulator
- B2 Pressure line (full operational pressure) from pressure regulator to valve unit
- B3 Pressure line (full operational pressure) from valve unit to level control valve on rear axle
- B4 Pressure line (reduced pressure) from valve unit to level control valves on front axle
- B5 Pressure line (full operational pressure) from pressure regulator to brake booster
- B6 Pressure line (reduced pressure) valve unit to actuating valve
- B7 Pressure line (reduced pressure) from actuating valve to air horn
- C Return flow collecting pipe to anti-freeze device
- C1 Return flow line from pressure regulator
- C2 Return flow line from level control valves to valve unit
- C3 Return flow line from valve unit
- C4 Return flow line from brake booster
- D Air control line for increased height from valve unit to level control valve
- E1 Junction line between level control valve and front axle air suspension
- E2 Junction line between level control valve and rear axle air suspension

• Visual inspection

Check the following for leakages, chafing, dents, cracks and corrosion:

Air filter
Anti-freeze device
Air compressor
Air reservoir tank
Pressure regulator (only on type 100)
Valve unit
Level control valves

Air chambers
Hoses and pipe lines

Note: Hairline cracks on the outer rubber coating of the bellows are without effect (see also item 676).

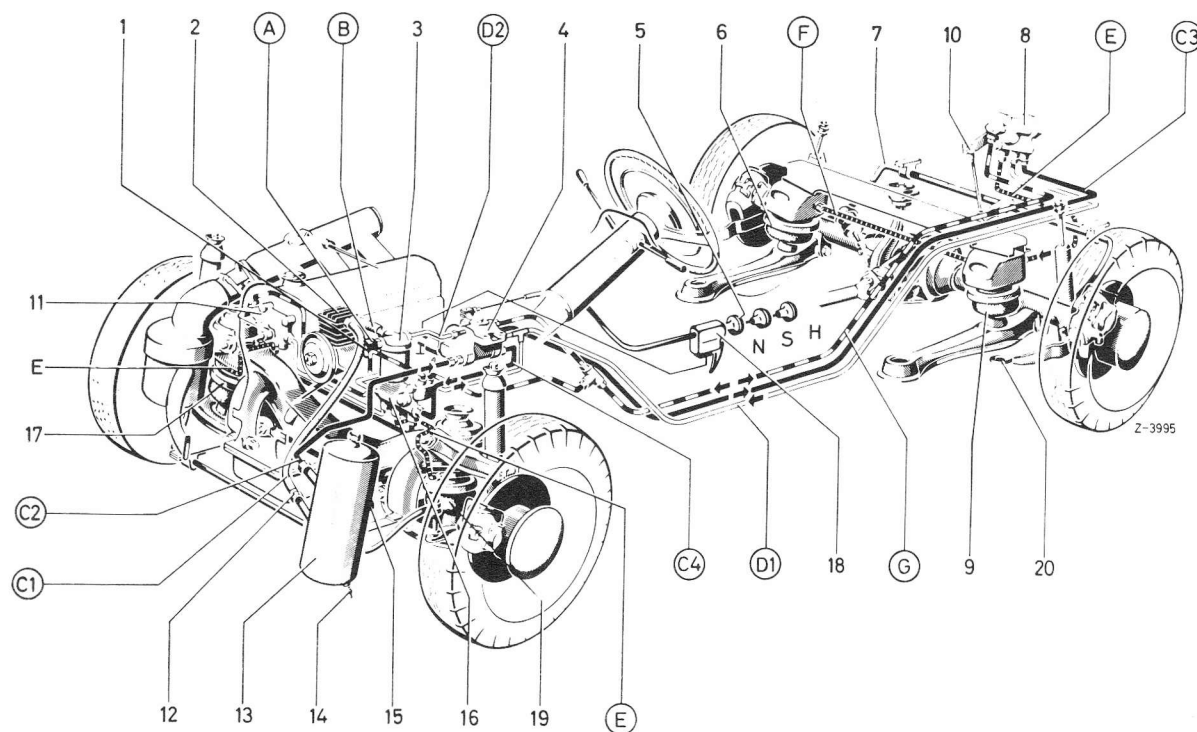

Type 109

- | | | | |
|----|---|----|----------------------------------|
| A | Air suction inlet and air release | 1 | Air filter |
| B | Air intake line from anti-freeze device to air compressor | 2 | Air compressor |
| C1 | Pressure line (full operational pressure) from air compressor to air reservoir tank | 3 | Anti-freeze device |
| C2 | Pressure line (full operational pressure) from air reservoir tank to valve unit | 4 | Valve unit |
| C3 | Pressure line (full operational pressure) from valve unit to level control valve on rear axle | 5 | Warning lamp |
| C4 | Pressure line (reduced pressure) from valve unit to level control valve on front axle | 6 | Air chamber on rear axle |
| D1 | Return flow line from level control valve to valve unit | 7 | Rear axle torsion bar |
| D2 | Return flow line from valve unit to anti-freeze device | 8 | Level control valve on rear axle |
| E | Connection line between level control valves and air suspension | 9 | Spring bellows on rear axle |
| F | Compensating line between air suspension on rear axle | 10 | Level control valve tie rod |
| G | Pressure control line for increased height from valve unit to level control valves | 11 | Front right level control valve |
| | | 12 | Non-return valve |
| | | 13 | Air reservoir tank |
| | | 14 | Drain valve |
| | | 15 | Air inlet valve |
| | | 16 | Front left level control valve |
| | | 17 | Air chamber on front axle |
| | | 18 | Valve unit cable |
| | | 19 | Air bellows on front axle |
| | | 20 | Anti-dive bar |